

# 2017 PAVEMENT CONDITIONS

## LEGEND

- LIMITED ACCESS HIGHWAY
- STATE ROUTE AND NUMBER
- STATE MAINTAINED BRIDGE ON TOWNSHIP ROAD
- TOWNSHIP ROAD, NUMBER AND SEGMENT LENGTH IN MILES
- IMPASSABLE TOWNSHIP ROAD
- TURNBACK TOWNSHIP ROAD
- OTHER ROAD
- RAILROAD (IN SERVICE)
- RAILROAD ABANDONED (TRACK RETAINED)
- STATE BOUNDARY
- COUNTY BOUNDARY
- TOWNSHIP BOUNDARY
- CITY OR BOROUGH BOUNDARY
- MUNICIPAL BUILDING
- SPLIT MILEAGE BETWEEN MUNICIPALITIES

- 300 AVONDALE RD
- 301 AUBURN RD
- 302 BAKER STATION RD
- 303 PENNOCK LA
- 305 VALLEY RD
- 306 NOSQUITO LA
- 307 HILTON RD
- 308 MCCUE RD
- 309 HILLTOP RD
- 310 WALTER RD
- 311 PRANG RD
- 321 GARDEN STATION RD
- 327 SULLIVAN RD
- 337 HEPBURN RD
- 339 INDIAN RUN RD
- 345 TICE RD
- 353 LONDON GROVE RD
- 357 BOODYVIER RD
- 358 LLOYD RD
- 360 HIPPINS RD
- 364 GUERNSEY RD
- 378 SCHOOL HOUSE RD
- 382 HOWELL WOODRE RD
- 384 ROSE HILL RD
- 386 LANGBOROUGH RD
- 387 PASCHALL HILL RD
- 388 GLEN WILLOW RD
- 389 STATE RD
- 442 ELLICOTT RD
- 500 HANNUM WILL RD
- 549 LAKE RD
- 550 STRODE RD
- 551 CHURCH AL
- 552 WELCONE AV
- 554 HOLLY DR
- 555 BUTTERNUT LA
- 556 OAK LA
- 560 PORTER RD
- 561 BUTTONWOOD DR
- 562 BUTTONWOOD PL
- 563 NOVA LA
- 564 GREENFIELDS LA
- 565 BELL LA
- 566 BRIAR CHASE DR
- 567 LONDON WAY
- 568 STRATFORD DR
- 569 WORTHINGTON DR
- 570 SHEFFIELD DR
- 571 NOTTINGHAM DR
- 572 MEADOW WOODS LA
- 573 MISTY HOLLOW DR
- 574 CLAY CREEK RD
- 575 SULLIVAN CHASE DR
- 576 ROOSEVELT WAY
- 577 TRUMAN LA
- 578 FRANKLIN CT
- 579 ROSE ANN LA
- 580 CHATHAM CHASE DR
- 581 HUNTER CREEK LA
- 582 RAYMOND AV
- 583 CHARTWELL RD
- 584 MEETINGHOUSE RD
- 585 SPENCER RD
- 586 DINGEE RD
- 587 HEATHER GROVE LA
- 588 SURPRISE CT
- 589 GLOSSOM CT
- 590 NEWFIELD CT
- 591 DEERPETH CT
- 592 ARBOR CT
- 593 BRANBLE LA
- 594 CHAMBERS WAY
- 595 ANGELICA DR
- 596 BELMONT CIR
- 597 RUSHFORD PL
- 598 HOLLAND CT
- 599 GLENN IRIS CT

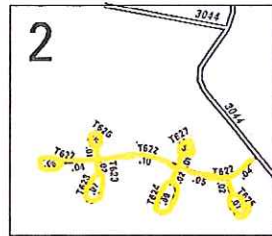

3:1

- 600 WELLSVILLE LA
- 601 LETCHMORTH LA
- 602 FRIENDSHIP LA
- 603 RISCOY PL
- 604 JACK REYNOLDS WAY
- 605 VINCENT PL
- 606 CAVERSHAM DR
- 607 JAMISON CIR
- 608 PENNSFORD CIR
- 609 BRAE BURN CIR
- 610 BRIAR CLIFF CIR
- 611 MCKEAN CIR
- 612 STAFFORD DR
- 613 NEWTON CIR
- 614 CABOT CIR
- 615 SAGE CIR
- 616 NEW COVENANT CT
- 617 LAKENHEATH CT
- 618 LIVERPOOL LA
- 619 HAMMERSMITH CT
- 620 CAMBERWELL DR
- 621 HEATHERBROOK CT
- 622 KENT FARM LA
- 623 FLINTLOCK CIR
- 624 WARDUS WAY
- 625 AIRDALE CIR
- 626 EATON WAY
- 627 BRANDON CIR
- 628 GAUGE BLVD
- 629 GRACE LA
- 630 NELSON RD
- 631 MARTHAS WAY
- 632 HATHAN PL
- 633 JAY CS
- 634 JOHN WILSON CIR
- 635 EDNA JANE LA
- 636 RADENCE LA
- 637 DOORINGS RD
- 638 WREATH RD
- 639 MARTIN DR
- 640 DYLAN CIR
- 641 JOYCE CIR
- 642 BELLENEADE CIR
- 643 WESTVIEW DR
- 644 ROUSE DR
- 645 PAR CT
- 646 EARLE CT
- 647 STRAND RD
- 648 WHITESTONE RD
- 649 ELPHIN RD
- 650 CASKEY LA
- 651 ARINGA WAY
- 652 TULSK RD
- 653 ATHELONE WAY
- 659 LANGDON RIDGE RD
- 660 CONREY TRL
- 661 MARY ANN CT

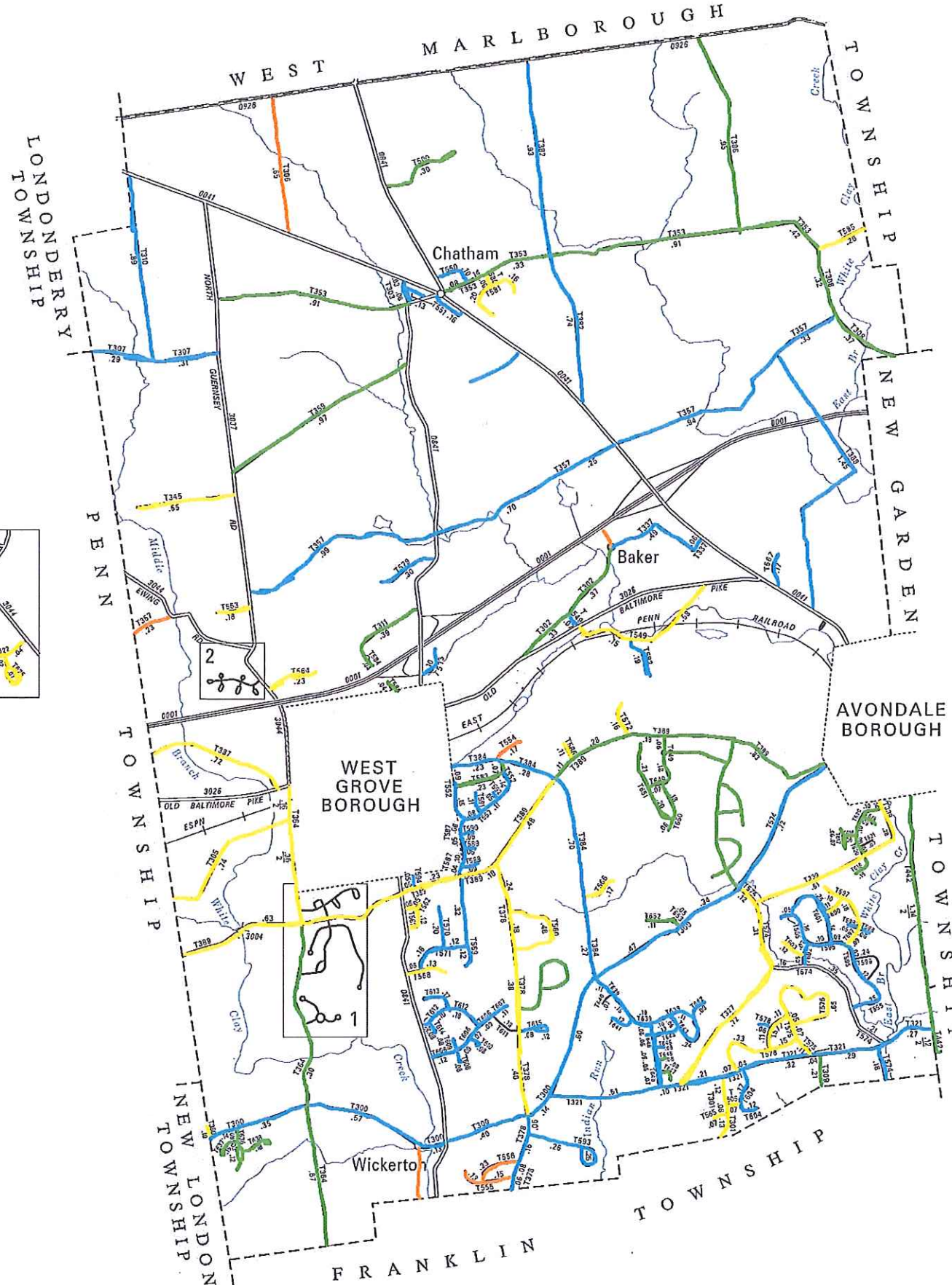

TOTAL MILES	
Township Road System	58.00*
State Highway System	19.27
<b>Total</b>	<b>77.27</b>

\* Includes ACT 32 Turnback Mileage of 4.16

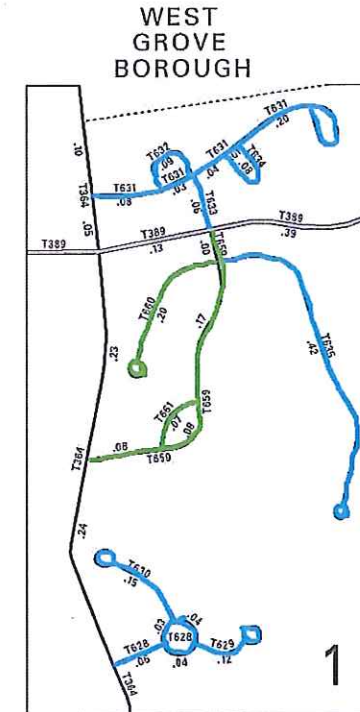

- 9-10 Very Good Condition
- 7-8 Good Condition
- 5-6 Fair Condition
- 3-4 Poor Condition
- 0-2 Failed Roadway

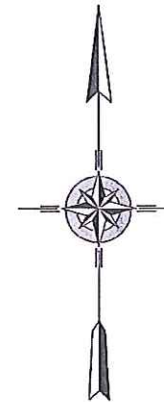

## LONDON GROVE SECOND CLASS TOWNSHIP MAP CHESTER COUNTY

PREPARED BY THE  
PENNSYLVANIA DEPARTMENT OF TRANSPORTATION  
BUREAU OF PLANNING AND RESEARCH  
GEOGRAPHIC INFORMATION DIVISION  
IN COOPERATION WITH THE  
U.S. DEPARTMENT OF TRANSPORTATION  
FEDERAL HIGHWAY ADMINISTRATION  
MUNICIPAL CODE 15 222

REVISED PER FORM 990 DATED 12-2-16

