

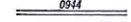









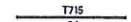

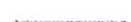
2017 PAVEMENT IMPROVEMENT PROJECTS

LEGEND

-  LIMITED ACCESS HIGHWAY
-  STATE ROUTE AND NUMBER
-  STATE MAINTAINED BRIDGE ON TOWNSHIP ROAD
-  TOWNSHIP ROAD, NUMBER AND SEGMENT LENGTH IN MILES
-  IMPASSABLE TOWNSHIP ROAD
-  TURNBACK TOWNSHIP ROAD
-  OTHER ROAD
-  RAILROAD (IN SERVICE)
-  RAILROAD ABANDONED (TRACK RETAINED)
-  STATE BOUNDARY
-  COUNTY BOUNDARY
-  TOWNSHIP BOUNDARY
-  CITY OR BOROUGH BOUNDARY
-  MUNICIPAL BUILDING
-  SPLIT MILEAGE BETWEEN MUNICIPALITIES

- 300 AVONDALE RD
- 301 AUBURN RD
- 302 BAKER STATION RD
- 303 PENNOCK LA
- 305 VALLEY RD
- 306 MOSSQUITO LA
- 307 HILTON RD
- 308 McCUE RD
- 309 HILLTOP RD
- 310 WALTER RD
- 311 FRANG RD
- 321 GARDEN STATION RD
- 327 SULLIVAN RD
- 337 HEPBURN RD
- 339 INDIAN RUN RD
- 345 TICE RD
- 353 LONDON GROVE RD
- 357 WOODVIEW RD
- 359 LOTO RD
- 360 HIPKINS RD
- 364 GUERNSEY RD
- 378 SCHOOL HOUSE RD
- 382 HOBELL MOORE RD
- 384 ROSE HILL RD
- 386 LANBORNDOWN RD
- 387 PASCHALL WILL RD
- 388 GLEN WILLOW RD
- 389 STATE RD
- 442 ELLICOTT RD
- 500 HANUM WILL RD
- 545 LAKE RD
- 550 STRODE RD
- 551 CHURCH AL
- 552 WELCOME AV
- 554 HOLLY DR
- 558 BUTTERNUT LA
- 556 OAK LA
- 560 PORTER RD
- 561 BUTTWOOD DR
- 562 BUTTWOOD PL
- 563 NOVA LA
- 564 GREENIELDS LA
- 565 BELL LA
- 566 BRIAR CHASE DR
- 567 LONDON WAY
- 568 STRATFORD DR
- 569 NORTHINGTON DR
- 570 SHEFFIELD DR
- 571 NOTTINGHAM DR
- 572 MEADOW WOODS LA
- 573 WISTY HOLLOW DR
- 574 CLAY CREEK RD
- 575 SULLIVAN CHASE DR
- 576 ROOSEVELT WAY
- 577 TRUMAN LA
- 578 FRANKLIN CT
- 579 ROSE ANN LA
- 580 CHATHAM CHASE DR
- 581 HUNTER CREEK LA
- 582 RAYMOND AV
- 583 CHARTELL RD
- 584 MEETINGHOUSE RD
- 585 SPENCER RD
- 586 DINGEE RD
- 587 HEATHER GROVE LA
- 588 SUNRISE CT
- 589 BLOSSOM CT
- 590 HEMP FELD CT
- 591 DEERPATH CT
- 592 ARBOR CT
- 593 BRAMBLE LA
- 594 CHAMBERS WAY
- 595 ANGELICA DR
- 596 BELMONT CIR
- 597 RUSHFORD PL
- 598 HOLLAND CT
- 599 GLENN IRIS CT

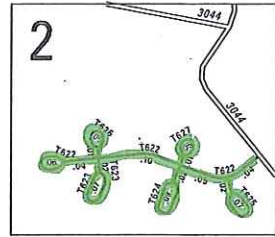

3:1

- 600 WELLSVILLE LA
- 601 LETCHWORTH LA
- 602 FRIENDSHIP LA
- 603 WISCOY PL
- 604 JACK REYNOLDS WAY
- 605 VINCENT PL
- 606 CAVERSHAW DR
- 607 JANISON CIR
- 608 PENNFORD CIR
- 609 BRAE BURN CIR
- 610 BRIAR CLIFF CIR
- 611 MCKEAN CIR
- 612 STANFORD DR
- 613 HERTON CIR
- 614 CABOT CIR
- 615 SAGE CIR
- 616 NEW COVENANT CT
- 617 LAKENHEATH CT
- 618 LIVERPOOL LA
- 619 HAMMERSMITH CT
- 620 CAMBERNELL DR
- 621 HEATHERBROOK CT
- 622 KENT FARM LA
- 623 FLINTLOCK CIR
- 624 MARCUS WAY
- 625 AIRDALE CIR
- 626 EATON WAY
- 627 BRANDON CIR
- 628 GAUGE BLVD
- 629 GRACE LA
- 630 NELSON RD
- 631 BARTHAS WAY
- 632 HATHAN PL
- 633 JAY CS
- 634 JOHN WILSON CIR
- 635 EDNA JANE LA
- 636 RADENCE LA
- 637 MOORINGS RD
- 638 BREATH RD
- 639 MARTIN DR
- 640 DYLAN CIR
- 641 JOYCE CIR
- 642 BELLEHEADE CIR
- 643 RESTIVIER DR
- 644 ROUSE DR
- 645 PAR CT
- 646 EAGLE CT
- 647 STRAND RD
- 648 WHITESTONE RD
- 649 ELPHIN RD
- 650 EASKEY LA
- 651 ARINGA WAY
- 652 TULSK RD
- 653 ADELONE WAY
- 659 LANBORN RIDGE DR
- 660 CONREY TRL
- 661 MARY ANN CT

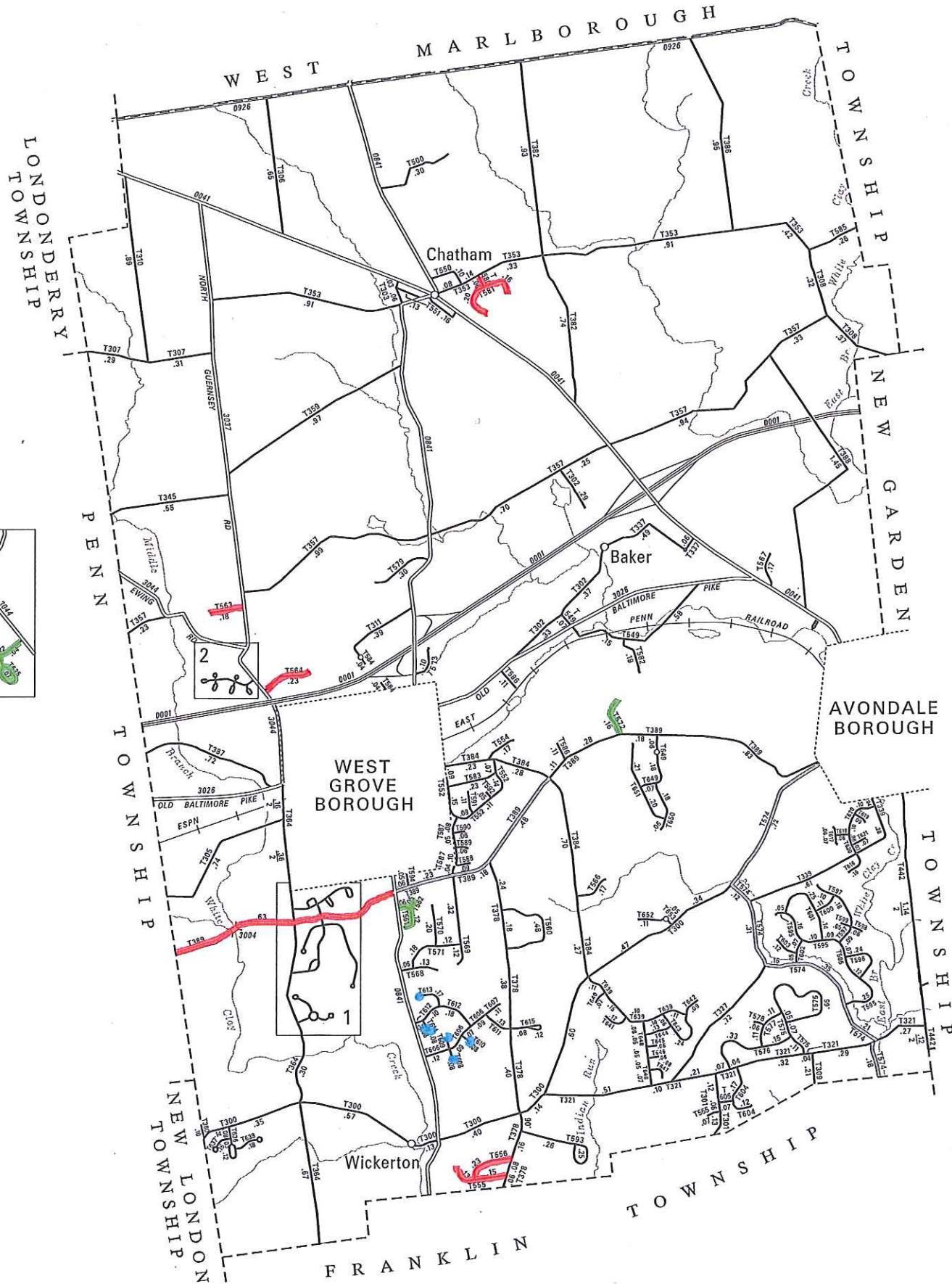

TOTAL MILES	
Township Road System	58.00*
State Highway System	19.27
Total	77.27

* Includes ACT 32 Turnback Mileage of 4.16

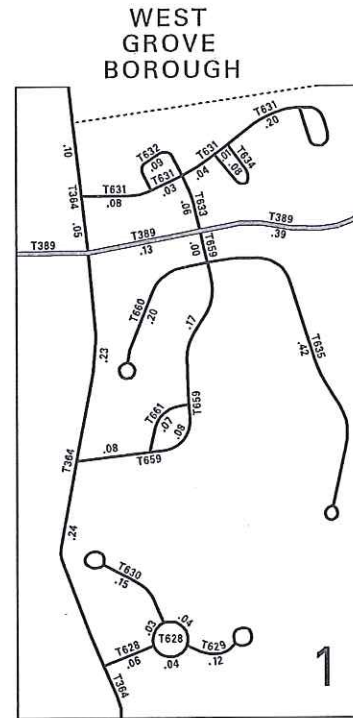

3:1

- NEW ASPHALT SURFACE
- SURFACE TREATMENT
- INFILL EXISTING CENTER ISLAND CUL-DE-SACS

LONDON GROVE
SECOND CLASS TOWNSHIP MAP
CHESTER COUNTY

PREPARED BY THE
PENNSYLVANIA DEPARTMENT OF TRANSPORTATION
BUREAU OF PLANNING AND RESEARCH
GEOGRAPHIC INFORMATION DIVISION
IN COOPERATION WITH THE
U.S. DEPARTMENT OF TRANSPORTATION
FEDERAL HIGHWAY ADMINISTRATION
MUNICIPAL CODE 15 222

REVISED PER FORM 990 DATED 12-2-16

