

2017 PAVEMENT IMPROVEMENT 3 YEAR PLAN

LEGEND

- LIMITED ACCESS HIGHWAY
- STATE ROUTE AND NUMBER
- STATE MAINTAINED BRIDGE ON TOWNSHIP ROAD
- TOWNSHIP ROAD, NUMBER AND SEGMENT LENGTH IN MILES
- IMPASSABLE TOWNSHIP ROAD
- TURNBACK TOWNSHIP ROAD
- OTHER ROAD
- RAILROAD (IN SERVICE)
- RAILROAD ABANDONED (TRACK RETAINED)
- STATE BOUNDARY
- COUNTY BOUNDARY
- TOWNSHIP BOUNDARY
- CITY OR BOROUGH BOUNDARY
- MUNICIPAL BUILDING
- SPLIT MILEAGE BETWEEN MUNICIPALITIES

- 300 AVONDALE RD
- 301 AUBURN RD
- 302 BAKER STATION RD
- 303 PENNOCK LA
- 305 VALLEY RD
- 306 MOSQUITO LA
- 307 HILTON RD
- 308 McCUE RD
- 309 HILLTOP RD
- 310 WALTER RD
- 311 PRANG RD
- 321 GARDEN STATION RD
- 327 SULLIVAN RD
- 337 HEPBURN RD
- 338 INDIAN RUN RD
- 345 TICE RD
- 353 LONDON GROVE RD
- 357 BOOVIEW RD
- 358 LLOYD RD
- 360 HIPKINS RD
- 364 GUERNSEY RD
- 378 SCHOOL HOUSE RD
- 382 HOBELL WOODS RD
- 384 ROSE HILL RD
- 386 LAMBORNDOWN RD
- 387 PASCHALL MILL RD
- 388 GLEN WILLOW RD
- 389 STATE RD
- 442 ELLICOTT RD
- 500 HANNUM MILL RD
- 545 LAKE RD
- 550 STRUDE RD
- 551 CHURCH AL
- 552 WELCOME AV
- 554 HOLLY DR
- 555 BUTTERNUT LA
- 556 OAK LA
- 560 PORTER RD
- 561 BUTTWOOD DR
- 562 BUTTWOOD PL
- 563 NOVA LA
- 564 GREENFIELDS LA
- 565 BELL LA
- 566 BRIAR CHASE DR
- 567 LONDON WAY
- 568 STRATFORD DR
- 569 WORTHINGTON DR
- 570 SHEFFIELD DR
- 571 NOTTINGHAM DR
- 572 MEADOW WOODS LA
- 573 WISTY HOLLOW DR
- 574 CLAY CREEK RD
- 575 SULLIVAN CHASE DR
- 576 ROOSEVELT WAY
- 577 TRUMAN LA
- 578 FRANKLIN CT
- 579 ROSE ANN LA
- 580 CHATHAM CHASE DR
- 581 HUNTER CREEK LA
- 582 RAYMOND A
- 583 CHARTWELL RD
- 584 MEETINGHOUSE RD
- 585 SPENCER RD
- 586 DINGEE RD
- 587 HEATHER GROVE LA
- 588 SUNRISE CT
- 589 BLOSSOM CT
- 590 NEWFIELD CT
- 591 DEERPATH CT
- 592 ARBOR CT
- 593 BRAMBLE LA
- 594 CHAMBERS WAY
- 595 ANGELICA DR
- 596 BELMONT CIR
- 597 RUSHFORD PL
- 598 HOLLAND CT
- 599 GLENN TRIS CT

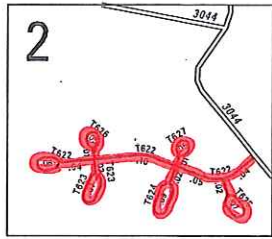

3:1

- 600 WELLSVILLE LA
- 601 LETCHNORTH LA
- 602 FRIENDSHIP LA
- 603 WISCOY PL
- 604 JACK REYNOLDS WAY
- 605 VINCENT PL
- 606 CAVERSHAM DR
- 607 JAMISON CIR
- 608 PENNFORD CIR
- 609 BRAE BURN CIR
- 610 BRIAR CLIFF CIR
- 611 MCKEAN CIR
- 612 STANFORD DR
- 613 NEWTON CIR
- 614 CABOT CIR
- 615 SAGE CIR
- 616 NEW COVENANT CT
- 617 LAKENHEATH CT
- 618 LIVERPOOL LA
- 619 HAMBERSMITH CT
- 620 CAMBERWELL DR
- 621 HEATHERBROOK CT
- 622 KENT FARM LA
- 623 FLINTLOCK CIR
- 624 WARCUS WAY
- 625 AIRDALE CIR
- 626 EATON WAY
- 627 BRANDON CIR
- 628 GAUGE BLVD
- 629 GRACE LA
- 630 NELSON RD
- 631 MARTHAS WAY
- 632 MATHAN PL
- 633 JAY CS
- 634 JOHN WILSON CIR
- 635 EDNA JANE LA
- 636 RADGENCE LA
- 637 WOORINGS RD
- 638 WREATH RD
- 639 MARTIN DR
- 640 DYLAN CIR
- 641 JOYCE CIR
- 642 BELLEHADE CIR
- 643 WESTVIEW DR
- 644 ROUSE DR
- 645 PAR CT
- 646 EAGLE CT
- 647 STRAND RD
- 648 WHITSTONE RD
- 649 ELPHIN RD
- 650 EASKEY LA
- 651 ARINGA WAY
- 652 TULSK RD
- 653 ATELONE WAY
- 659 LAMBORN RIDGE RD
- 660 CONREY TRL
- 661 MARY ANN CT

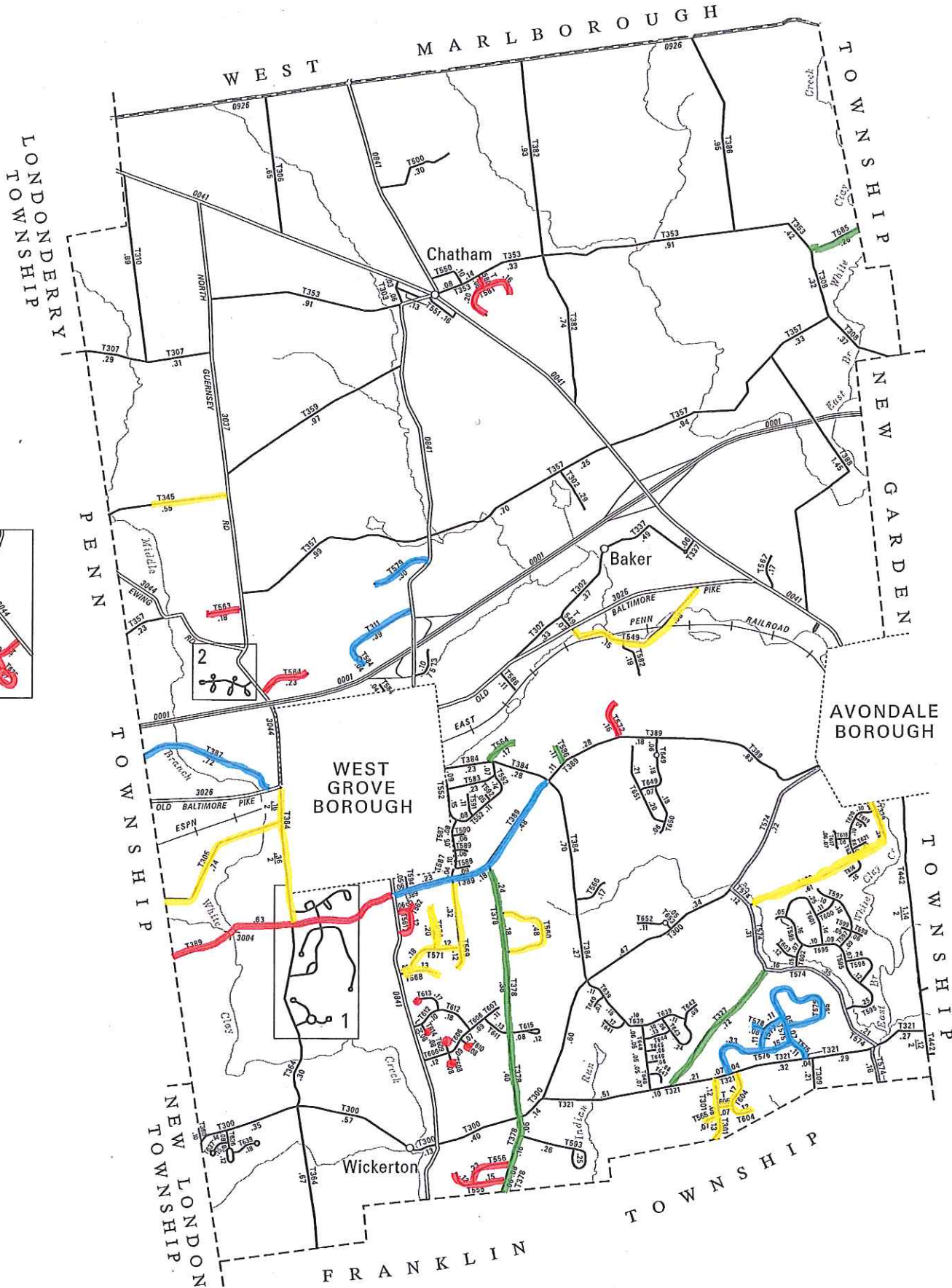

|                      |        |
|----------------------|--------|
| TOTAL MILES          |        |
| Township Road System | 58.00* |
| State Highway System | 19.27  |
| Total                | 77.27  |

\* Includes ACT 32 Turnback Mileage of 4.16

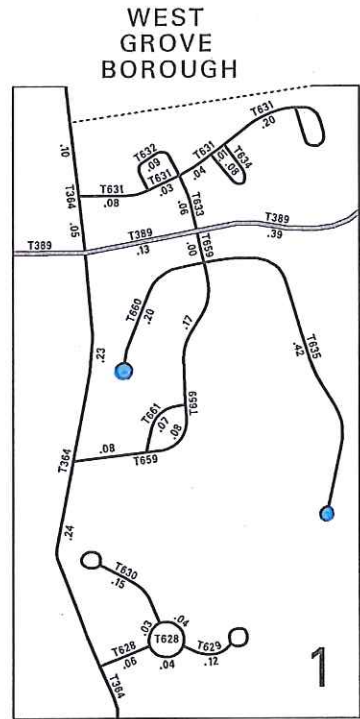

3:1

- 2017
- 2018
- 2019
- 2020

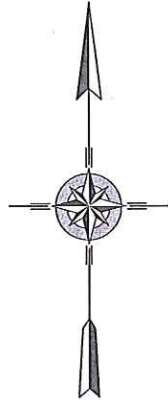

LONDON GROVE  
SECOND CLASS TOWNSHIP MAP  
CHESTER COUNTY

PREPARED BY THE  
PENNSYLVANIA DEPARTMENT OF TRANSPORTATION  
BUREAU OF PLANNING AND RESEARCH  
GEOGRAPHIC INFORMATION DIVISION  
IN COOPERATION WITH THE  
U.S. DEPARTMENT OF TRANSPORTATION  
FEDERAL HIGHWAY ADMINISTRATION  
MUNICIPAL CODE 15 222

REVISED PER FORM 990 DATED 12-2-16

